

**G/F PLAN - CAMPUS B**  
at FILLING SCHOOL (Year 9-11)

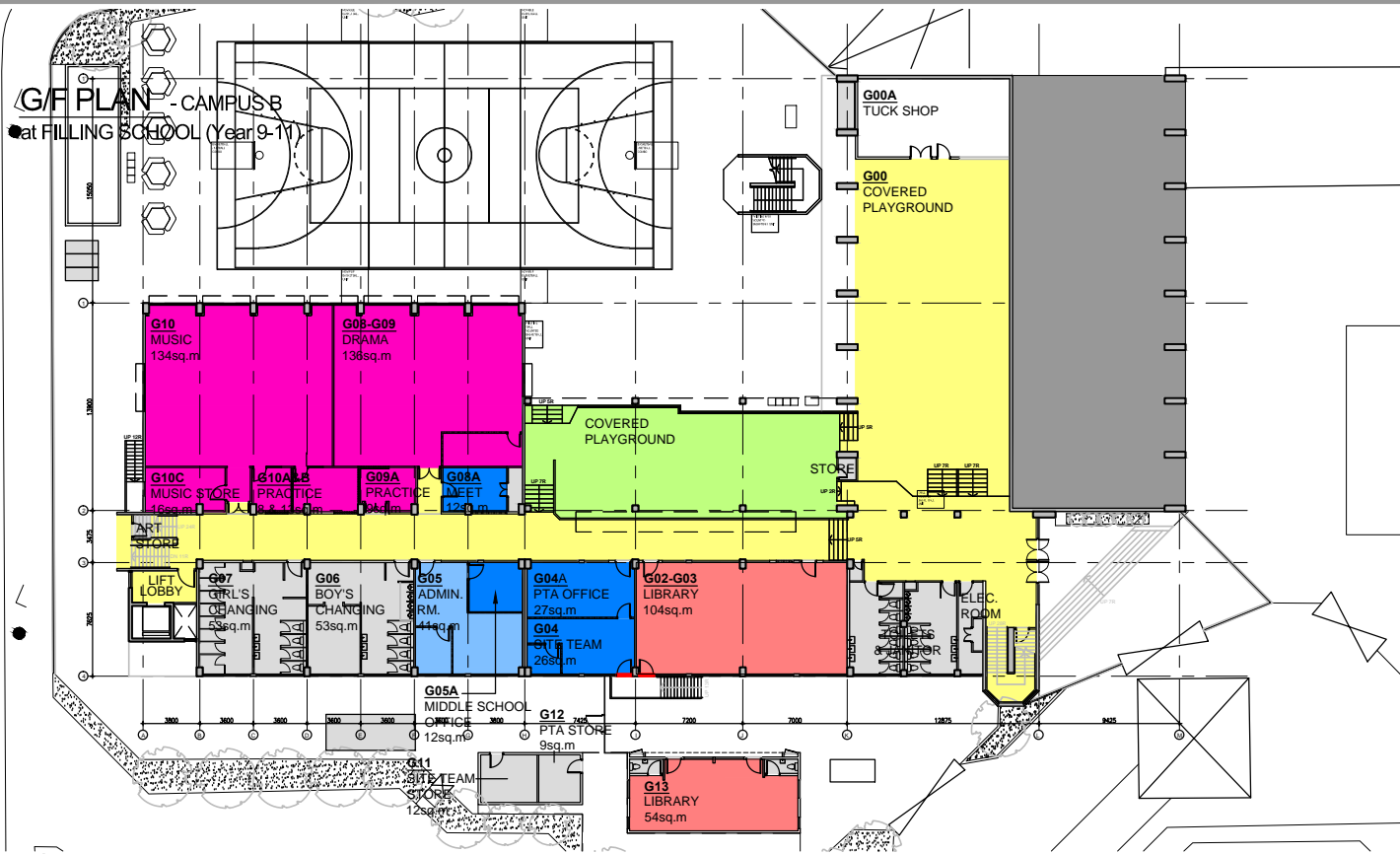

**1/F PLAN - CAMPUS B**  
at FILLING SCHOOL (Year 9-11)

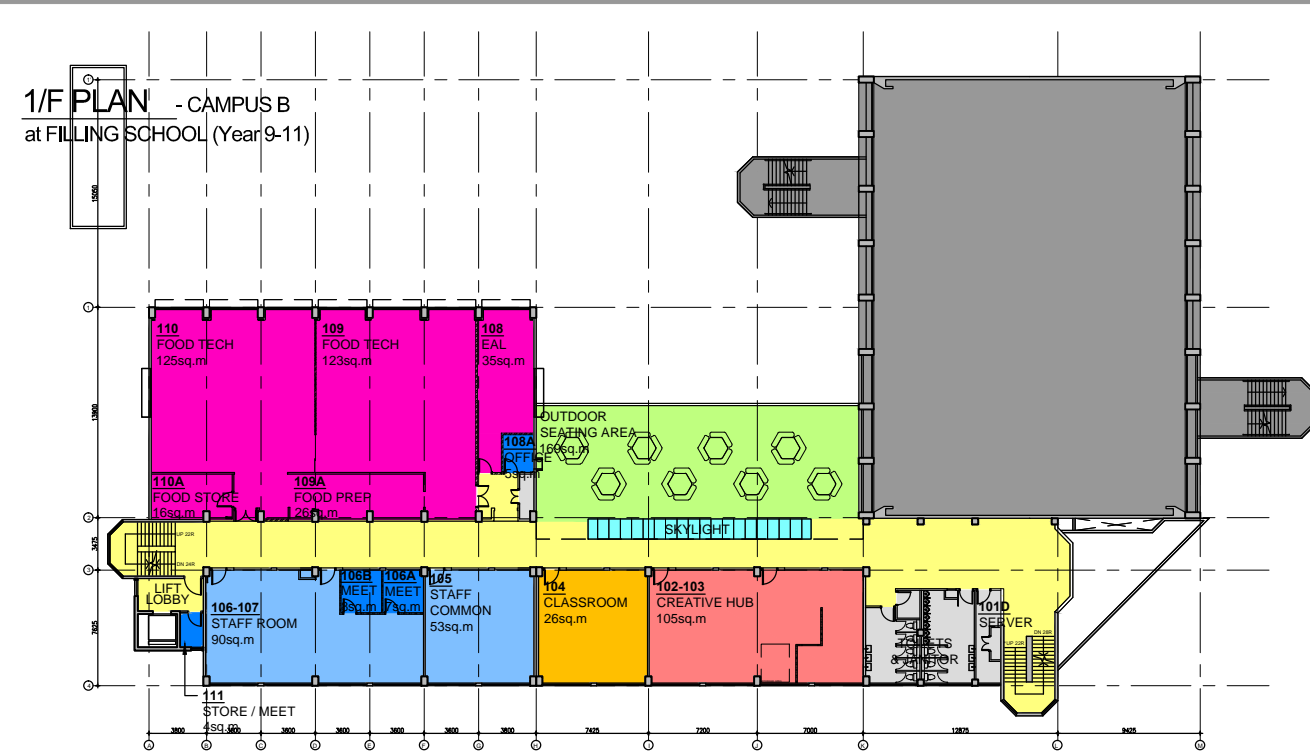

**2/F PLAN - CAMPUS B**  
at FILLING SCHOOL (Year 9-11)

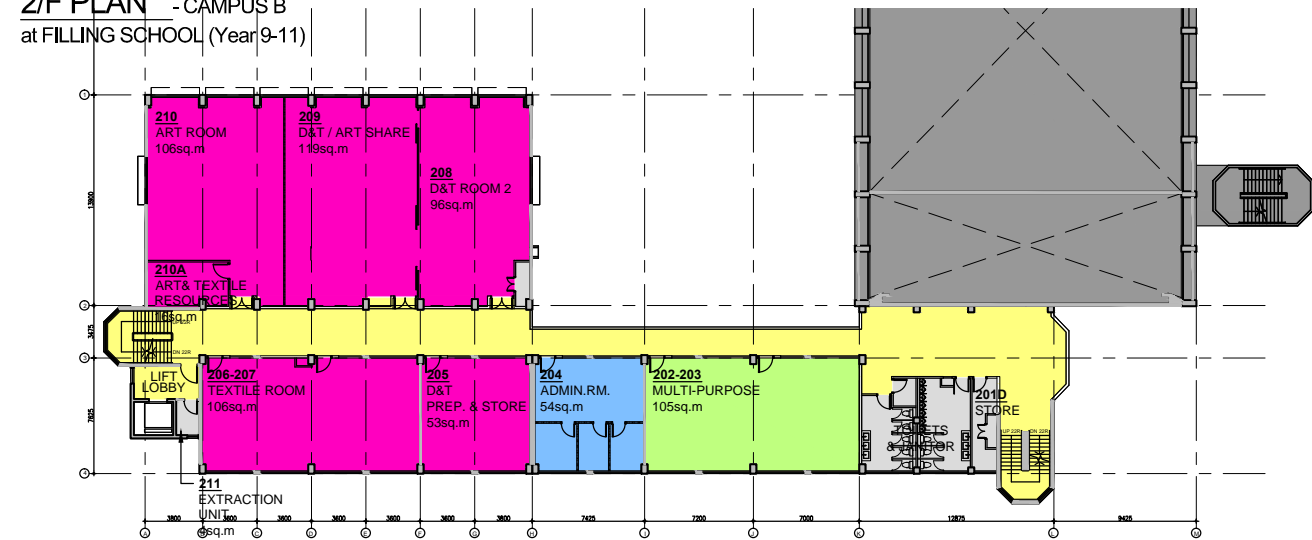

**3/F PLAN - CAMPUS B**  
at FILLING SCHOOL (Year 9-11)

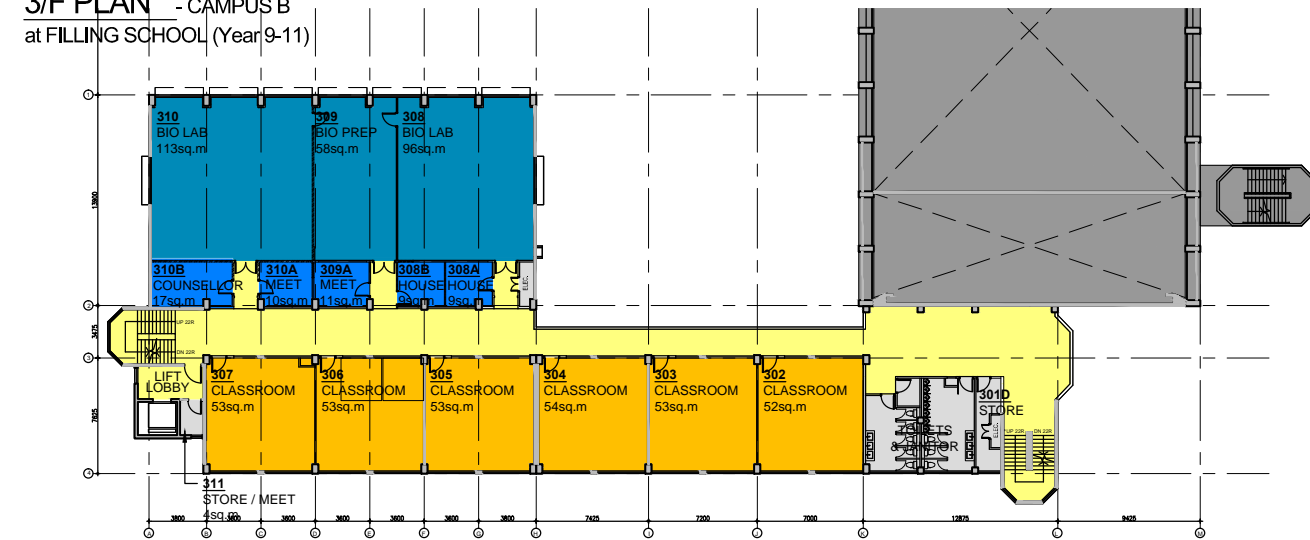

**4/F PLAN - CAMPUS B**  
at FILLING SCHOOL (Year 9-11)

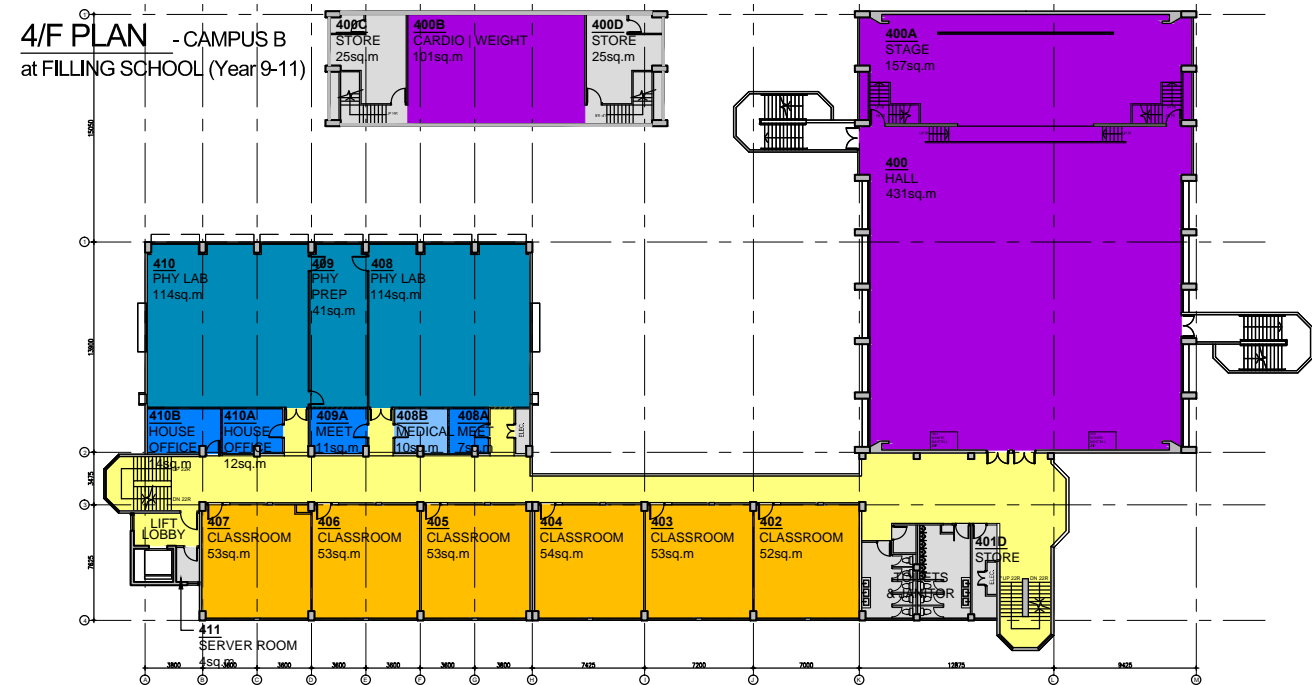

**5/F PLAN - CAMPUS B**  
at FILLING SCHOOL (Year 9-11)

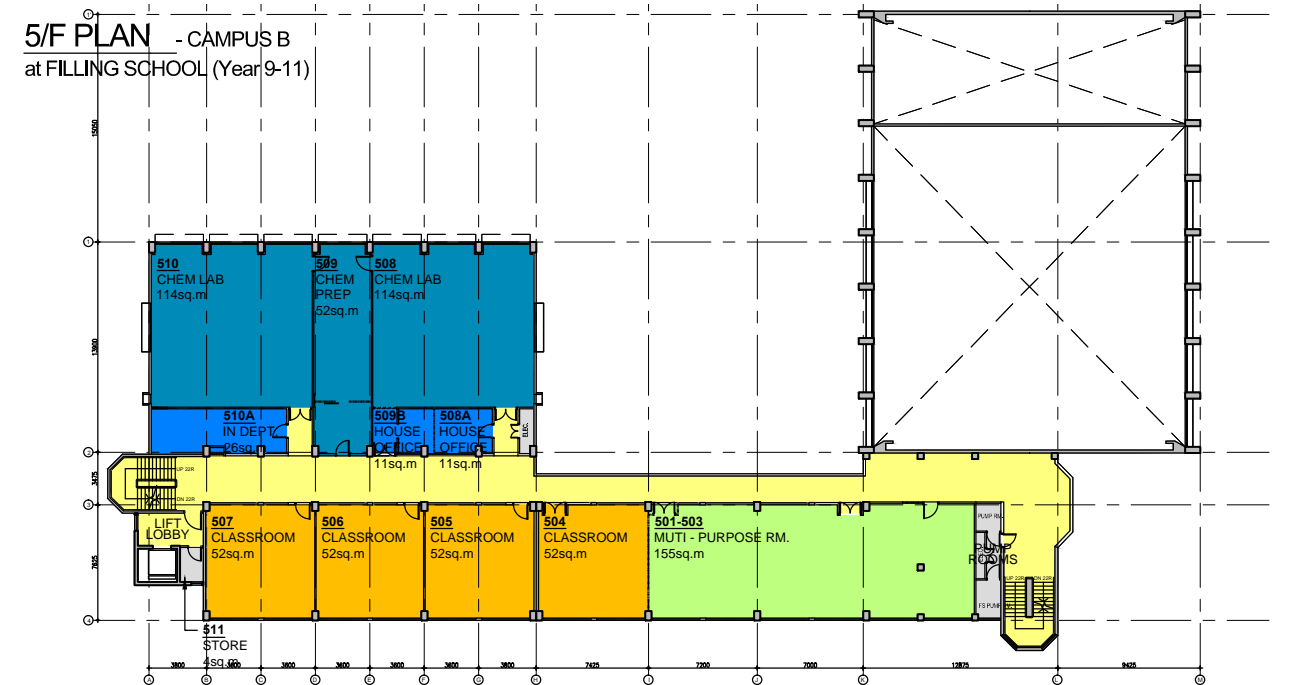

- CLASSROOMS
- SPECIAL ROOMS
- LABORATORY
- LIBRARY / CREATIVE HUB
- ASSEMBLY HALL
- STAFF ROOM / ADMIN OFFICE
- SMALL OFFICE / MEETING ROOMS
- TOILET & STORE
- COMMUNAL / MULTI-PURPOSE SPACES
- TUCK SHOP / BOOTH
- CIRCULATION

REV.	DATE	DESCRIPTION	APPROVED / CHECKED BY
8	SEP.14	LAYOUT UPDATE	PS/BT
7	MAR.19	TENDER RESPONSE	PS/BT
6	APR.10	TENDER RESPONSE	PS/BT
5	MAR.17	SCOPE REVIEW UPDATE	PS/BT
4	OCT.16	SCOPE REVIEW UPDATE	PS/BT
3	JUN.16	DD REPORT UPDATE	PS/BT
2	MAR.16	DD REPORT	PS/BT
1	APR.16	UPDATED LAYOUT	PS/BT
0	FEB.16	LAYOUT	PS/BT

**Project**  
PREPARATION OF  
DECANTING SITES FOR  
ISLAND SCHOOL  
REDEVELOPMENT

**Drawing Title**  
OVERALL LAYOUT PLANS  
AT  
FILLING SCHOOL  
(Year 9-11)  
CAMPUS B

**Drawing No.**  
ISD\_D-020 (B-Overall)

Project Ref : T 15679  
Scale : 1:500

**Thomas Chow Architects Limited**  
22/F, Eastern Harbour Centre  
22 Harbour Street, Quarry Bay  
Hong Kong  
TEL : 3588 9640 FAX : 2516 5105

Signature for Submission/Construction

